

NEWS RELEASE

Please find here a news release issued today by Worldwide Flight Services (WFS)

Media contact: Jamie Roche, JRPR

Date: 29 November 2021

T: + 44 (0) 1753 900902

E: jamie@jamierochepr.co.uk

COPENHAGEN AIRPORT ACKNOWLEDGES WFS' LATEST EXPANSION AS ENABLING 'FUTURE AIRFREIGHT GROWTH'



Copenhagen Airport has acknowledged Worldwide Flight Services' (WFS) latest investment to expand its cargo handling facilities as enabling 'future airfreight growth' for the airport and its airline clients.

WFS is the largest cargo handler in Copenhagen, supporting 31 airlines with flights to and from the Danish capital. It also provides cargo handling services for a further 127 offline carriers. It opened its first 4,600m² cargo terminal in Copenhagen in 2008 and expanded with an additional 3,000m² Terminal 2 facility at the beginning of 2010. In 2019, WFS also invested in a new GDP-certified Pharma facility, increasing its footprint by a further 1,500m².

WFS – the world's largest air cargo handler – is investing once again by signing a contract for a new Terminal 3 cargo centre. The 3,700m² warehouse facility will open in Q4 2022. In the meantime, to support its airline customers' growing volumes, WFS has taken a 12-month lease on an additional facility to provide the additional

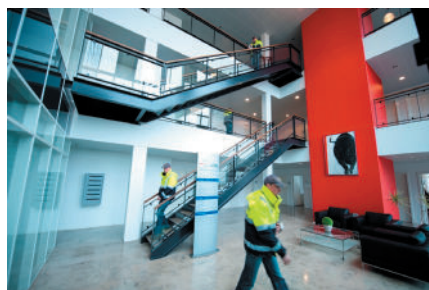

capacity it needs in the short-term, until construction of the new cargo centre is completed next year.



Thomas Woldbye, Group CEO of Copenhagen Airports has praised WFS' commitment to the airport and its cargo community. "With this significant expansion of an additional handling terminal, WFS has ensured further improvement and capacity for growth in the airfreight segment in Copenhagen Airport. This fits well with Copenhagen Airport's cargo strategy and will enable opportunities for future airfreight growth. Throughout the covid-19 pandemic, WFS has proven to be a solid partner and maintained good



contingency, which has contributed to the airfreight market receiving a stable and good service in CPH under these difficult conditions and large fluctuations in the volumes of airfreight in our region," he stated.

In the past 12 months, WFS has renewed airline contracts at Copenhagen Airport with Qatar Airways and Sichuan Airlines, and now handles 100,000 tonnes of cargo annually across its facilities, as well as providing airside cargo handling. In addition to facilitating rising general cargo volumes, WFS' investment at the airport is also important in supporting Medicin Valley, the strongest life science cluster in the Nordic countries, which spans the Greater Copenhagen area. It is home to a vibrant ecosystem underpinned by



Worldwide Flight Services

world-class life science universities and research infrastructure, including 350+ biotech, medtech and pharma companies with local R&D, 4 global R&D pharmaceutical companies, and seven science parks with a major focus on life science.



“Throughout the pandemic, WFS has continued to provide a full 24/7/365 cargo handling service for our customers in Copenhagen, including

those closely connected to the country’s thriving pharma industry. As volumes recover to close to their pre-covid level, and we see new growth potential ahead, we are able to make this new investment to ensure WFS and Copenhagen Airport have the infrastructure in place to maintain high quality cargo handling services, for both our existing clients and future customers which recognise this strategically-important regional cargo hub,” added Thomas Egeland, General Manager, WFS – Scandinavia.

-ends-

About WFS

Founded in 1993 and headquartered in Paris, WFS (www.wfs.aero) is the world’s largest air cargo handler and one of the leading providers of ground handling and technical services with annual revenues of over EUR1.1 billion. Its 22,300 employees serve more than 270 airlines at 170 major airports in 20 countries on five continents.